

# ECORAIN



## GENERAL DATA

### Applications

**ECORAIN Essential** is a complete and pre-assembled system for using rainwater. The system comprises a recyclable polyethylene tank, an ECOPLUS 240 and Mascontrol and a three-way automatic valve assembled on suction port of the pump. The system has been designed to be wall-mounted. Supplied with wall bracket and float switch, with 65 ft. of cable, as a standard.

**ECORAIN Evolution & Advanced** are complete and pre-assembled system for using rainwater in one or two-family houses.

The system comprises a recyclable polyethylene console, a completely automatic electronic control unit, three-way automatic valve and ECOPLUS 240 electric pump.

Supplied with wall bracket as a standard and float switch with 65 ft of cable for ECORAIN Evolution version, or level sensor probe with 65 ft. of cable for ECORAIN Advanced.

### Constructional features of the pump

Technopolymer pump body and motor support.

Technopolymer impeller, diffuser, self-priming disc.

Carbon/ceramic mechanical seal.

### Constructional features of the motor

Induction motor, closed and cooled with external ventilation.

Rotor mounted on oversized greased sealed-for-life ball bearings to ensure silent running and a long life.

Built-in thermal and resettable overload protection on ECOPLUS 240

Capacitor permanently in circuit.

Manufactured according to UL 778 -2010 & CSA 108-1

Motor protection: NEMA3

Terminal Box protection: NEMA3

Insulation class: F

Standard voltage: 115v 60Hz

# TECHNICAL DATA

## MATERIALS ECORAIN ESSENTIAL

N°	PARTS	MATERIALS
1	PUMP CONTROL	MASCONTROL
2	PRESSURISED WATER OUTLET	PPO 30
3	RAIN WATER SUCTION	STEEL HOSE
4	3 - WAY VALVE	VALVE BODY - BRASS RETURN SPRING - STEEL MOTOR COVER - EXTINGUISHING ABS
5	BACK UP WATER TANK	PE
6	OVERFLOW	PP HOMOPOLYMER
7	PUMP	ECOPLUS 240
8	MUNICIPAL WATER INLET	STEEL HOSE
9	PRIMING PLUG	PPE / O RING NBR
10	DRAIN PLUG	PPE / O RING NBR

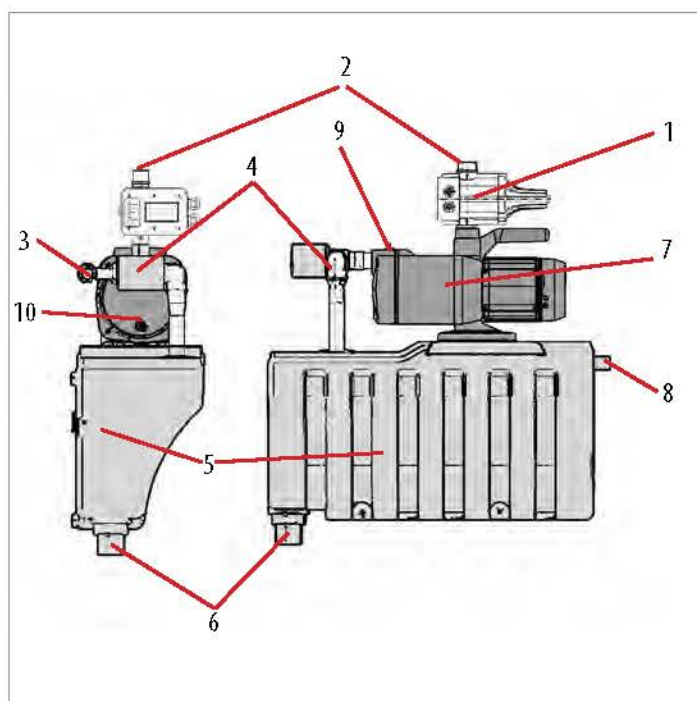

Operating Range:	From 1 to 27 gpm with a head up to 157ft (68psi)
Liquid quality requirements:	clean, free from solids or abrasive substances, non viscous, non aggressive, non crystallized, chemically neutral, close to the characteristics of water
Liquid temperature Range:	From 32°F to 95°F
Maximum suction depth	26 ft
Maximum ambient temp.	104°F
Maximum operating pressure	87 psi
Installation:	fixed or portable in a vertical position
Special version on request	other voltages and/or frequencies

# TECHNICAL DATA

## EVOLUTION & ADVANCED MATERIALS

N°	PARTS	MATERIALS
1	ENCLOSURE	PP FOAM
2	PUMP	ECOPLUS 240
3	PRESSURISED OUTLET	METAL HOSE
4	RAINWATER SUCTION	BRASS
5	3-WAY VALVE	VALVE BODY - BRASS RETURN SPRING - STEEL MOTOR COVER - EXTINGUISING ABS
6	PRESSURE GUAGE	BRASS - COPPER
7	FLOW SWITCH	POM - NBR - STEEL
8	WATER TANK	LLDPE
9	CONTROL PANEL	COVER - EXTINGUISNG ABS
10	MUNICIPAL INLET	METAL HOSE
11	EMERGENCY OVERFLOW	LLDPE
12	EXPANSION TANK	DIAPHRAGM - CHLOROBUTYL
13	CHECK VALVE	BRASS
14	PUMP MOUNTING	STEEL
15	FLOAT VALVE	PA 66 / STEEL / POLYSTYRENE

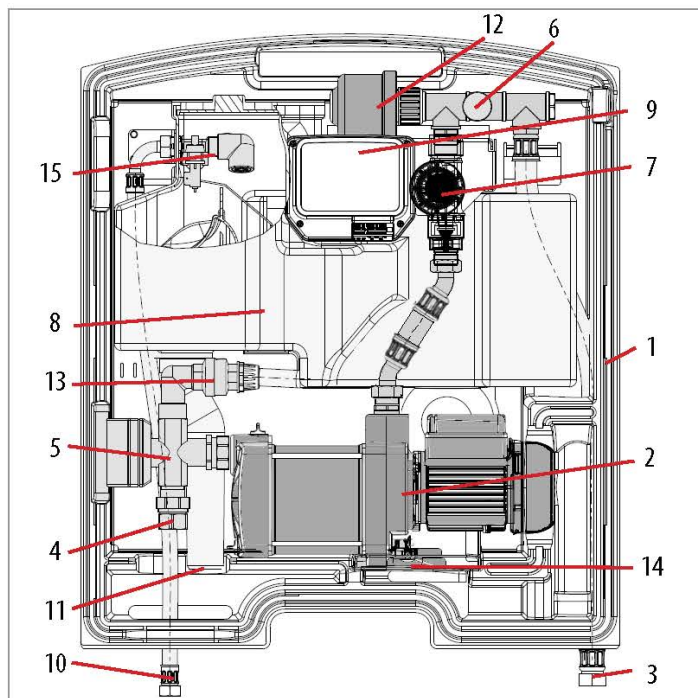

Operating Range:	From 1 to 27 gpm with a head up to 157ft (68psi)
Liquid quality requirements:	clean, free from solids or abrasive substances, non viscous, non aggressive, non crystallized, chemically neutral, close to the characteristics of water
Liquid temperature Range:	From 32°F to 104°F
Maximum Suction depth:	26 ft
Maximum ambient temp.	104°F
Maximum operating pressure	87 psi
Installation:	wall mounted, fixed horizontal position
Special version on request	other voltages and/or frequencies

# ECORAIN ESSENTIAL

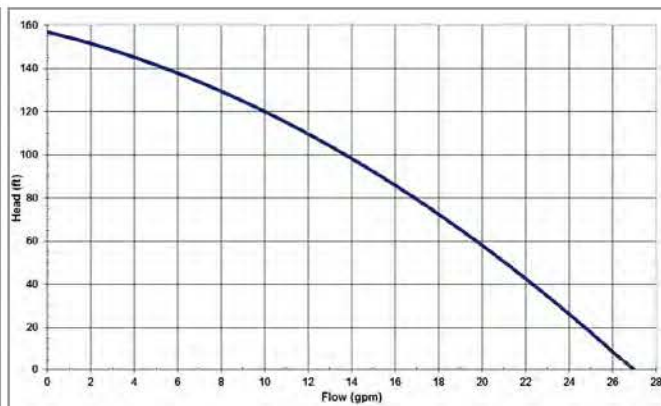
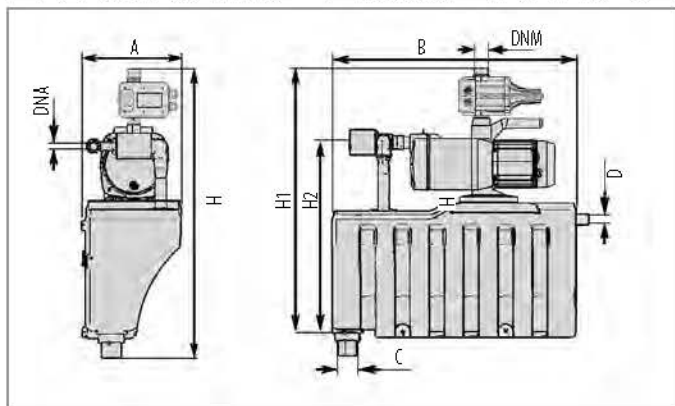

MODEL	A	B	C	D	H	H1	H2	DNA	DNM	Weight
ESSENTIAL	10 1/4"	25 5/8"	2"	3/4" NPT	28 3/4"	26 1/4"	19 3/4"	1" NPT	1" NPT	39.7 lbs

MODEL	ELECTRICAL DATA				HYDRAULIC DATA		
	Voltage 60Hz	P1 kW	Hp	In A	MAX Flow	Max Head	Max Pressure
ESSENTIAL	115v	1100	1	10.0	27 gpm	157 ft	68 psi

# ECORAIN EVOLUTION & ADVANCED

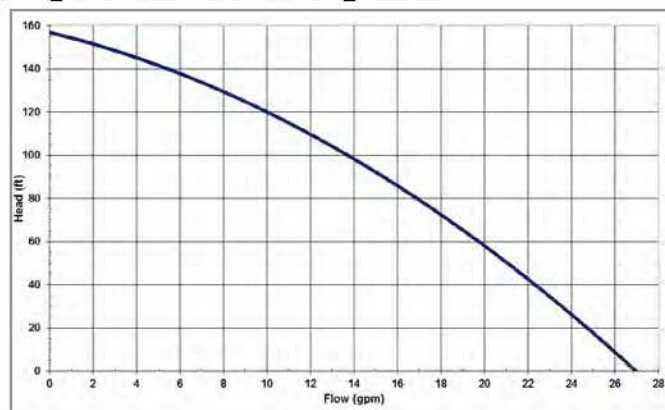
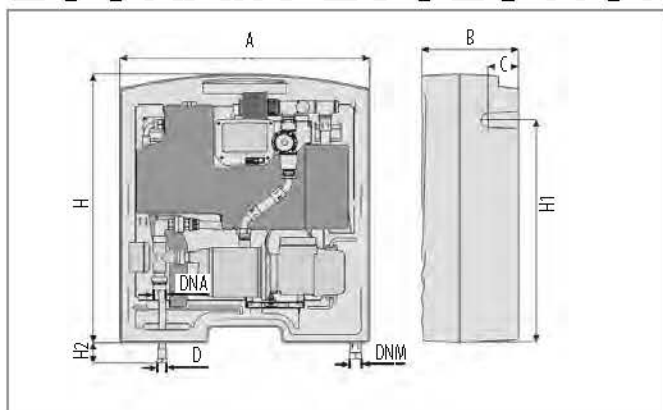

MODEL	A	B	C	D	H	H1	H2	DNA	DNM	Weight
ADVANCED & EVOLUTION	29 5/8"	11 3/8"	5 7/8"	3/4" NPT	33 3/8"	29 3/8"	2"	1" NPT	1" NPT	61.7 lbs

MODEL	ELECTRICAL DATA				HYDRAULIC DATA		
	Voltage 60Hz	P1 kW	Hp	In A	MAX Flow	Max Head	Max Pressure
ADVANCED & EVOLUTION	115v	1100	1	10.0	27 gpm	157 ft	68 psi